

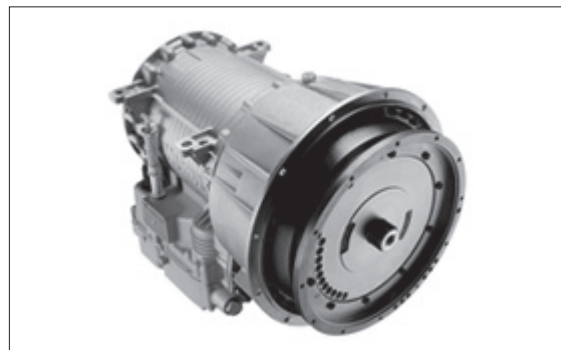

3700 Series



RATINGS

Model ⁽¹⁾		Input Torque Gross N•m (lb-ft)	Input Power Gross ⁽²⁾ Kw (hp)	Turbine Torque Net ⁽³⁾ N•m (lb-ft)	GVW kg (lbs)	GCW kg (lbs)
3700	General	990 (730)	205 (275)	1830 (1350)	n/a	n/a
	Refuse, Concrete Mixer	1254 (925)	239 (320)	1996 (1450)	n/a	n/a
3200 SP	Specialty / Military	1186 (875)	246 (330)	1996 (1450)	n/a	n/a

(1). Models including vocational designations (ie: ORS, OFS, SP, MH) are for global markets. All other models within this document are targeted for non North American markets only.

(2). Gross Power rating as defined by ISO 1585 or SAE J1995. (3). Turbine Torque limit based on iSCAN standard deductions.

DRIVETRAIN INTERFACES

Acceptable full-load engine governed speed	2000 – 2800 rpm
Acceptable engine idle speed range (with transmission in Drive)	500 – 800 rpm

MOUNTING

To Engine	SAE No.2
In Chassis	Rear mounting pads

TORQUE CONVERTER

Type One stage, three element, polyphase.
Includes standard integral damper which is operational in lockup.

Model	Stall Torque Ratio
TC-411	2.71
TC-413	2.44
TC-415	2.35
TC-417	2.20
TC-418	1.98
TC-419	2.02
TC-421	1.77

MECHANICAL RATIOS (Gear ratios do not include torque converter multiplication)

Range

First	6.93 : 1
Second	4.18 : 1
Third	2.24 : 1
Fourth	1.69 : 1
Fifth	1.20 : 1
Sixth	0.90 : 1
Seventh	0.78 : 1
Reverse	-5.00 : 1

CONTROL SYSTEM

Description	Allison 4th Generation Electronic Controls with closed loop adaptive shifts
Shift Sequences	[C = Converter mode (lockup clutch disengaged); L = Lockup mode (lockup clutch engaged)] Option 1: 1C-[1L]-2C-2L-3L-4L Option 2: 1C-[1L]-2C-2L-3L-4L-5L-6L Option 3: 1C-[1L]-2C-2L-3L-4L-5L-6L-7L
TCM must be calibrated for "1L" option. Second-gear-start calibrations are not available for all vehicle applications. First gear requires pre-selection.	
Driver-to-Transmission Interface	Cab-mounted shift selector, pushbutton or lever with two-digit display (range selected and range attained)
Communication Protocol - Engine/Vehicle Systems Interface	SAE J1939, SAE J1587, ISO 9141, IESCAN

PHYSICAL DESCRIPTION

	Length*	Dry Weight
With PTO Drive Provision	1310 mm (51.6 in)	530 kg (1170 lbs)
*Approximate length from engine housing to output flange (depending on output flange type)		

ENGINE-DRIVEN POWER TAKE-OFF PROVISION

Mounting pad positions viewed from rear	Drive gear rating with one PTO N•m (lb-ft)	PTO Drive Gear	Drive
8 o'clock (Standard)	660 (485)	68 tooth	Engine

OIL SYSTEM

Allison approved fluids: TES 295 and TES 389

Capacity, excluding external circuits 37 litres (39 quarts)

Main circuit oil filter Replaceable element, integral

Cooler circuit oil filter Replaceable element, integral

SPEEDOMETER PROVISION

Description	Non-zero-crossing square wave 9 or 18 pulses per revolution of transmission output shaft
Location	Electronic output from TCM

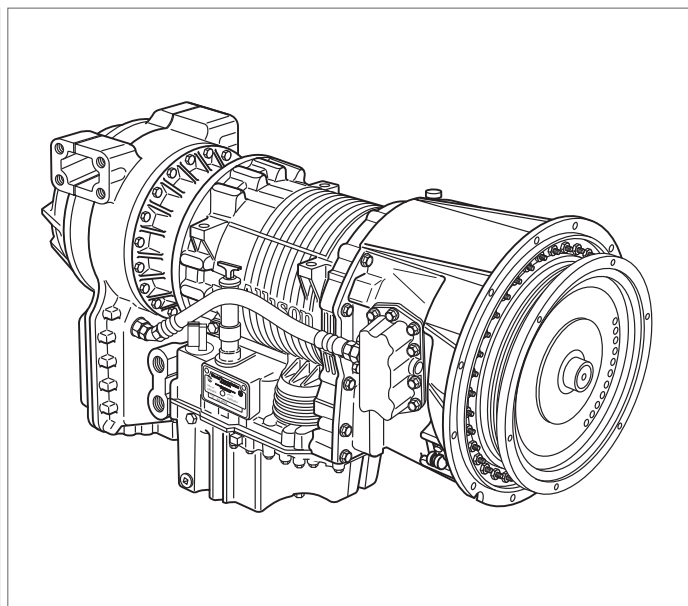
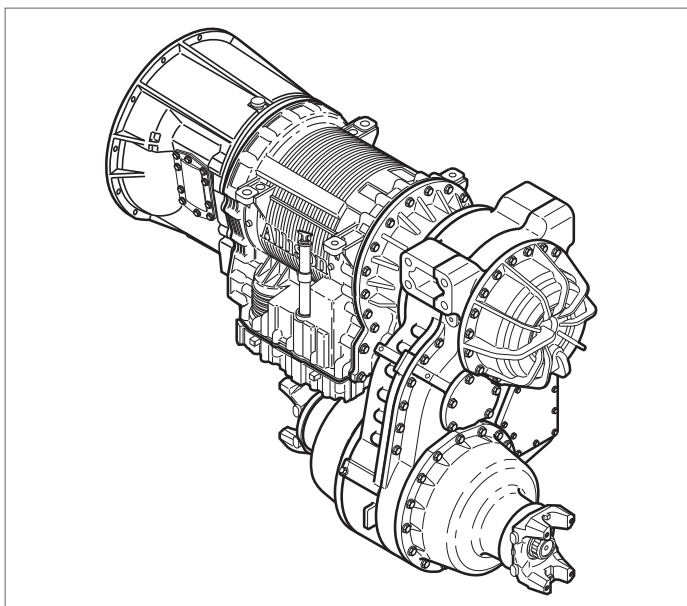
3700 Series**Contact Information:**

Transdiesel Australia Pty Ltd
77 McKellar Way, Epping, Victoria, Australia 3076
ph: (03) 9305 0800
www.transdiesel.com.au



www.allisontransmission.com

